

# LED Airfield Light

<b>Edge</b>	(white light)
<b>Threshold/End</b>	(red/green)
<b>Outer Threshold</b>	(green light)
<b>Holding Point</b>	(yellow light)
<b>Taxiway/Apron</b>	(blue light)

Designed to the requirements for Portable Lighting: CASA MOS Part 139 (Chapt 9.1.10 Portable Lighting)  
FAA Advisory Circular AC150/4653-50A - Sept 2005  
ICAO Annex 14 Vol 1, Ch 5, paragraph 5.3.2 Emergency Lighting

*Made in Australia*

**THE WSS SUPERLUX IS MADE FOR AIRFIELD OPERATORS WHOSE CRITICAL REQUIREMENTS ARE INDEPENDENT "ALL NIGHT LIGHTING", LONG-TERM RELIABILITY AND SIMPLE MAINTENANCE**

## APPLICATION

The WSS SuperLUX LED Airfield Light provides remote or low use aerodromes with a reliable and flexible solar powered runway lighting system. Our lights provide clearly defined runway guidance to assist pilots during approach, departure and circling using the latest technology "superflux" LED.

## PHOTOMETRIC

- > Colour temperature: 5500°K white
- > Rated life at 350mA, 25°C = 100,000hr
- > Moulded polycarbonate lens UV-stabilised
- > Light Pattern: Omni-directional (optimised approx 5° above horizontal)
- > Peak Luminous Intensity >50cd
- > Twilight activation switch level < 80 lux
- > Lumen Maintenance Figure (3W and 1W) specified as 70% at 50,000 hours.

## FRANGIBILITY

When correctly attached to the ground surface by the use of two metal pegs\*, WSS SuperLUX LED Airfield Lights will comply with the requirements of MOS Part 139 - 9.1.12 and ICAO Aerodrome Design Manual Part 4 (Visual Aids Chapter 15). Frangibility is achieved as a result of the light materials used in the construction and the low height profile (340mm) of the unit.

(Refer to Frangibility Statement for full details and notes)

## PHYSICAL

- > Diameter 450mm
- > Height 340mm (top of lens)
- > Weight 3.1 Kg (inc. battery)
- > Anchoring 2x 300mm steel pegs \*

## FEATURES

- > Superbright Luxeon® LED+ technology to suit remote airfield lighting applications
- > Vented and UV stabilised fibreglass cone also provides mandatory airfield ground markings
- > Battery mounted in vented protective enclosure
- > Solar panel in protective UV stabilised cover
- > Manual activation via magnetic switch
- > Special safety mode when airfield unserviceable
- > Replaceable solar panel, battery and LED for simple in-field maintenance and/or upgrading.

## CONFIGURATION

- > Longitudinal spacing, typically 90m
- > Lateral spacing, 3m beyond runway edge
- > Threshold/End lights require 4 (min) at each end
- > Outer Threshold in line with runway edge lights

## ORDERING

LUX - □ - □

COLOUR OF CONE  
W - WHITE  
D - DUN

LOCATION (LED COLOUR)  
EM - RUNWAY EDGE MARKER (CLEAR)  
TE - THRESHOLD / END (RED/GREEN)  
OT - OUTER THRESHOLD (GREEN)  
HP - HOLDING POINT (YELLOW)  
TX - TAXIWAY / APRON (BLUE)

ALL FIBREGLASS CONES ARE SUPPLIED COMPLETE WITH SOLAR PANEL, STANDARD LED ASSEMBLY (1W), CLEAR LENS, BATTERY MOUNTING BOX.

UNITS ARE SUPPLIED IN KNOCK DOWN FORM AND REQUIRE SOME ASSEMBLY BEFORE USE.

\* Pegs not supplied  
+ LED power depends on requirements such as light output and expected usage.

# SOLAR RECHARGED "ALL NIGHT" LIGHT LED Airfield Light

Parts Breakdown and  
Spares Identification

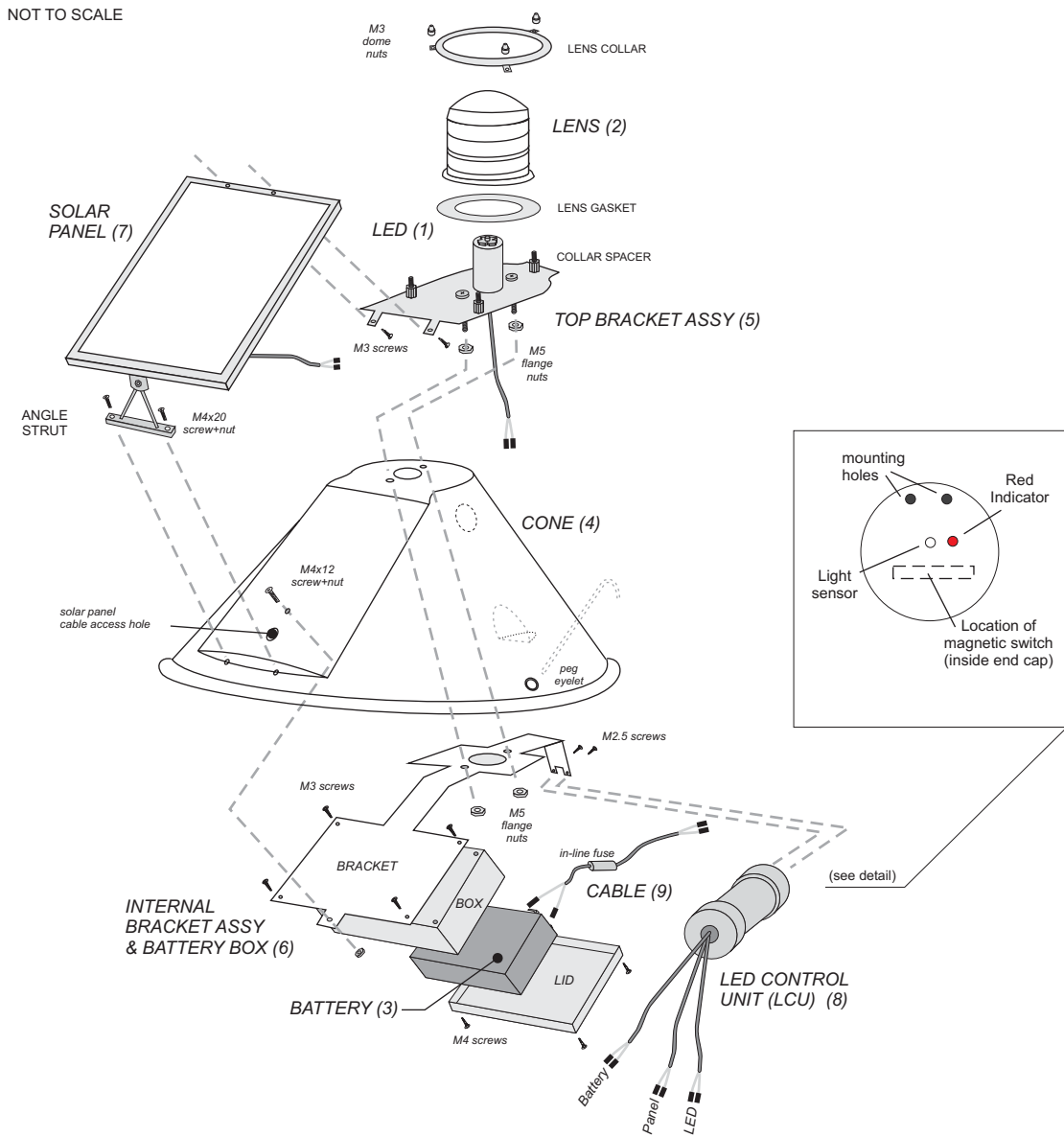

## REPLACEMENT PARTS



- 1.....LED - LED and Heatsink with leads
- 2.....LENS/x - Lens - Specify colour. Clear/C or Blue/B  
Lens - Split Red/Green (R-G) for combination runway threshold / end lights
- 3.....BAT/12-7 - Battery - Sealed Lead-Acid (12V 7.2 AH) (YUASA NPR-12FR)
- 4.....CONE/x - Cone only - NO fittings. Specify colour "x". /W (white) or /D = Dun
- 5.....BRKT/TOP - Top Bracket Assembly (includes lens collar, dome nuts and lens gasket)
- 6.....BRKT/INT - Internal Bracket Assembly (includes battery box and lid)
- 7.....PV/5-12 - Solar Panel (nom 4.5W, 12V - larger size available for latitudes >20°)
- 8.....LCU - LED Control Unit (Controller and Battery Monitor)
- 9.....CABLE - BATTERY CABLE SET including in-line fuse

